

DO NOT SCALE FROM THIS DRAWING
 CJZ DESIGN TO BE NOTIFIED OF
 DISCREPANCIES IN FIGURED DIMENSIONS.
 CONTRACTOR TO VERIFY ALL DIMENSIONS.
 THIS DRAWING IS COPYRIGHT.

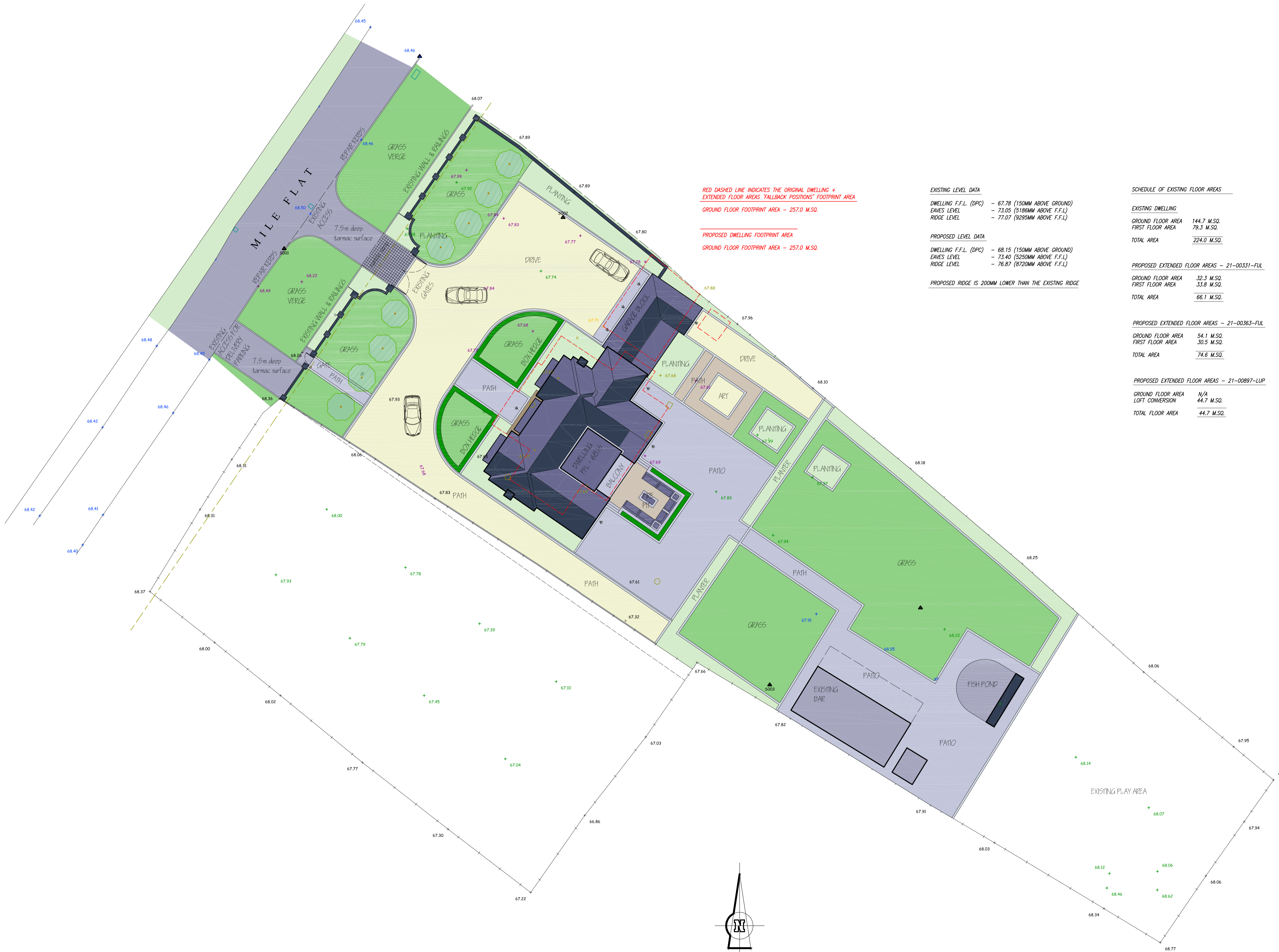
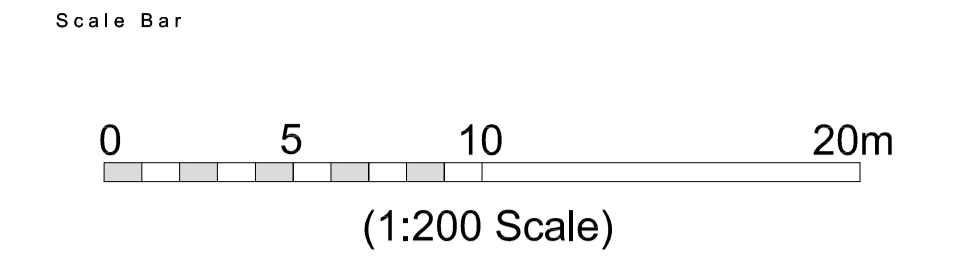

EXISTING LEVEL DATA
 DWELLING F.F.L (DPC) - 67.78 (150MM ABOVE GROUND)
 EAVES LEVEL - 73.05 (5195MM ABOVE F.F.L)
 RIDGE LEVEL - 77.07 (9295MM ABOVE F.F.L)

PROPOSED LEVEL DATA
 DWELLING F.F.L (DPC) - 68.15 (150MM ABOVE GROUND)
 EAVES LEVEL - 73.40 (5250MM ABOVE F.F.L)
 RIDGE LEVEL - 76.87 (9720MM ABOVE F.F.L)

SCHEDULE OF EXISTING FLOOR AREAS

EXISTING DWELLING	
GROUND FLOOR AREA	144.7 M.SQ.
FIRST FLOOR AREA	76.3 M.SQ.
TOTAL AREA	224.0 M.SQ.

PROPOSED EXTENDED FLOOR AREAS - 21-00331-FUL

GROUND FLOOR AREA	32.3 M.SQ.
FIRST FLOOR AREA	33.8 M.SQ.
TOTAL AREA	66.1 M.SQ.

PROPOSED EXTENDED FLOOR AREAS - 21-00363-FUL

GROUND FLOOR AREA	54.1 M.SQ.
FIRST FLOOR AREA	30.5 M.SQ.
TOTAL AREA	74.6 M.SQ.

PROPOSED EXTENDED FLOOR AREAS - 21-00897-LUP

GROUND FLOOR AREA	N/A
LOFT CONVERSION	44.7 M.SQ.
TOTAL FLOOR AREA	44.7 M.SQ.

PLANNING FALLBACK POSITION - INTERNAL FLOOR AREAS

ORIGINAL DWELLING & GARAGE	224.0 M.SQ.
APPLICATION TO EXTEND DWELLING (21-00331-FUL)	66.1 M.SQ.
LAWFUL DEVELOPMENT CERTIFICATE (21-00363-FUL)	74.6 M.SQ.
LAWFUL DEVELOPMENT CERTIFICATE (21-00897-FUL)	44.7 M.SQ.
TOTAL COMBINED FLOOR AREAS	409.4 M.SQ.

PROPOSED EXTENDED FLOOR AREAS - 21-01190-FUL

GROUND FLOOR AREA	233.7 M.SQ.
FIRST FLOOR AREA	175.0 M.SQ.
TOTAL FLOOR AREA	408.7 M.SQ.

PROPOSED REPLACEMENT DWELLING FLOOR AREA IS 0.7M.SQ. LESS THAN THE ESTABLISHED PLANNING FALLBACK POSITION

Rev	Description	Date

CJZ design
 ARCHITECTURAL DESIGN & DEVELOPMENT CONSULTANTS

CHURCH VIEW
 25 SCHOOL ROAD
 WOMBOURNE
 SOUTH STAFFORDSHIRE
 WV5 9EF

TELEPHONE : 01902 893252
 EMAIL : info@cjzdesign.co.uk
 WEBSITE : www.cjzdesign.co.uk

Project
PROPOSED DEVELOPMENT AT MILE FLAT HOUSE, MILE FLAT, KINGSWINFORM, WEST MIDLANDS, DY6 0AU

Drawing Title
SITE LAYOUT PLAN PROPOSED

Client
MR & MRS D. HISCOX

Project No.	Drawing No.	Revision
1287	50	E

Scale	Date	Drawn by
1:200@A1	OCT. 2021	CH

PLANNING INFORMATION