

# SITE LAYOUT PLAN

SCALE 1:500

SOUTH STAFFORDSHIRE DISTRICT COUNCIL

29 JUN 2020

KEY: RECEIVED



Mobile home

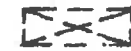

Tourer



Amenity building



Existing conifer hedge



Proposed hedge planting



Parking spaces.

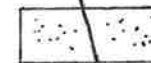

Grass

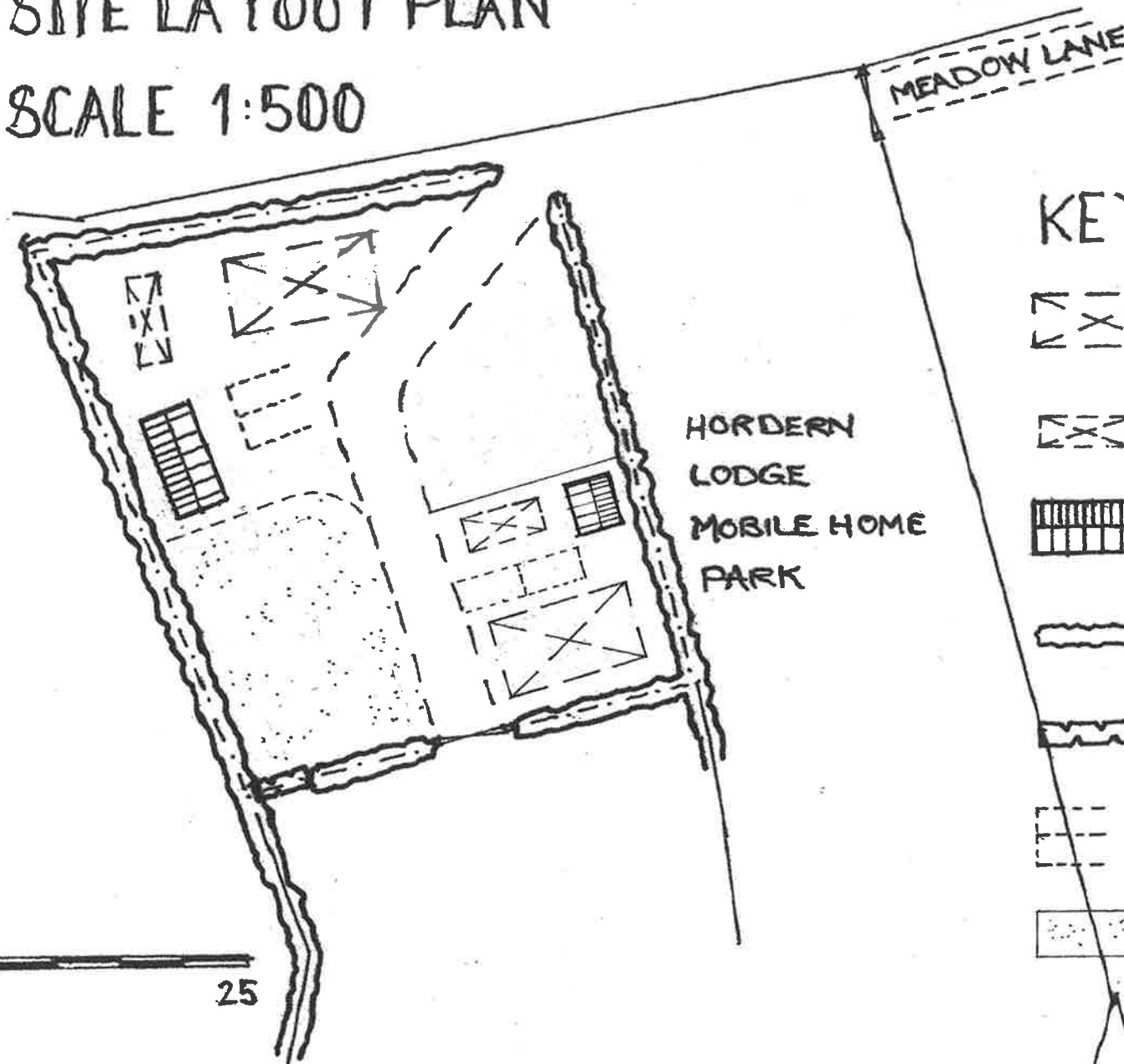

HORDERN  
LODGE  
MOBILE HOME  
PARK

0 25